

# VERTICAL ELECTROPHORESIS

## ALS-INS050



## DESCRIPTION

Vertical Electrophoresis ALS-INS050 is a widely used technique in molecular biology and biochemistry for separating proteins and nucleic acids based on their size and charge. The ALS-INS050 vertical electrophoresis units are designed as single-molded systems, eliminating the need for fabrication or adhesive joints, ensuring a leak-proof experience. These units feature a uniquely designed caster assembly that is simple to operate and guarantees a secure, leak-free performance.

## KEY FEATURES

- **In-Situ Gel Making Mode:** The gel making and running process is completed without dismantling the electrophoresis glass.
- **Non-Spring Latch Locking Mechanism:** The special design of the gel making base, locked by a non-spring latch, prevents leakage caused by spring pressure failure or aging.
- **Unique Card Plate Design:** The card plate with a whole gland allows the glass plate to be sealed using extrusion rubber strips, avoiding leakage and ensuring proper positioning.
- **Versatile Glass Plate and Gel Comb:** Different gel comb thicknesses (1.5 mm, 1.0 mm) (0.75 optional) allow adaptation to various sample loading needs.
- **Durable Material:** Made from high-quality transparent polycarbonate for durability and easy observation.
- **Molded Buffer Tank with Platinum Electrodes:** Pure platinum electrodes ensure consistent conductivity and results.
- **Safety Features:** The unit is designed to prevent buffer and gel leakage and has removable electrodes for easy maintenance. The system automatically powers off when the lid is removed for safe operation.
- **Wide Application:** Suitable for SDS-PAGE, native PAGE electrophoresis, and two-dimensional gel electrophoresis.
- **Soft Seals and Pressure Bars:** Ultra-soft silicone seals and pressure bars around the glass plates guarantee a leakproof gel casting experience.
- **Interchangeable Modules:** Designed for PAGE and electroblotting.
- **Pre-cast gel :** Suitable for use with pre-cast gel.



PREFABRICATED GEL SEAL



SPACER AND SHORT PLATES



GEL CASTING BASE

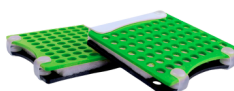

TRANSFER CASSETTE



COMB

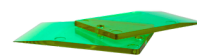

GEL CUTTING CARD

## TECHNICAL SPECIFICATIONS

SPECIFICATIONS	PARAMETERS
Model	ALS-INS050VE
Dimension(LxWxH)(mm)	185*108*125
Gel size (mm)	83*73
Comb Specifications	1.0mm :11 teeth 1.5mm: 11 teeth
Maximum Buffer Capacity	0.5L
Number of Gels	1-2

